

RHINOGATE™

**SLURRY
KNIFE GATE
VALVES**

RLB100

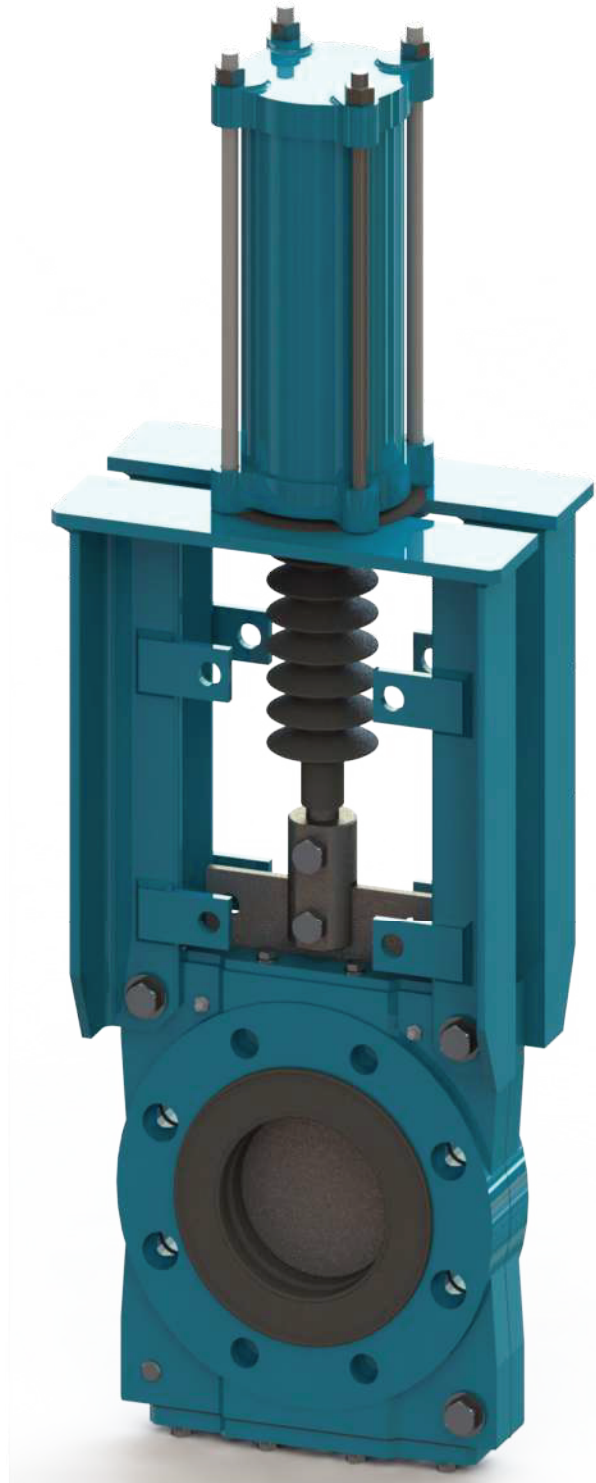
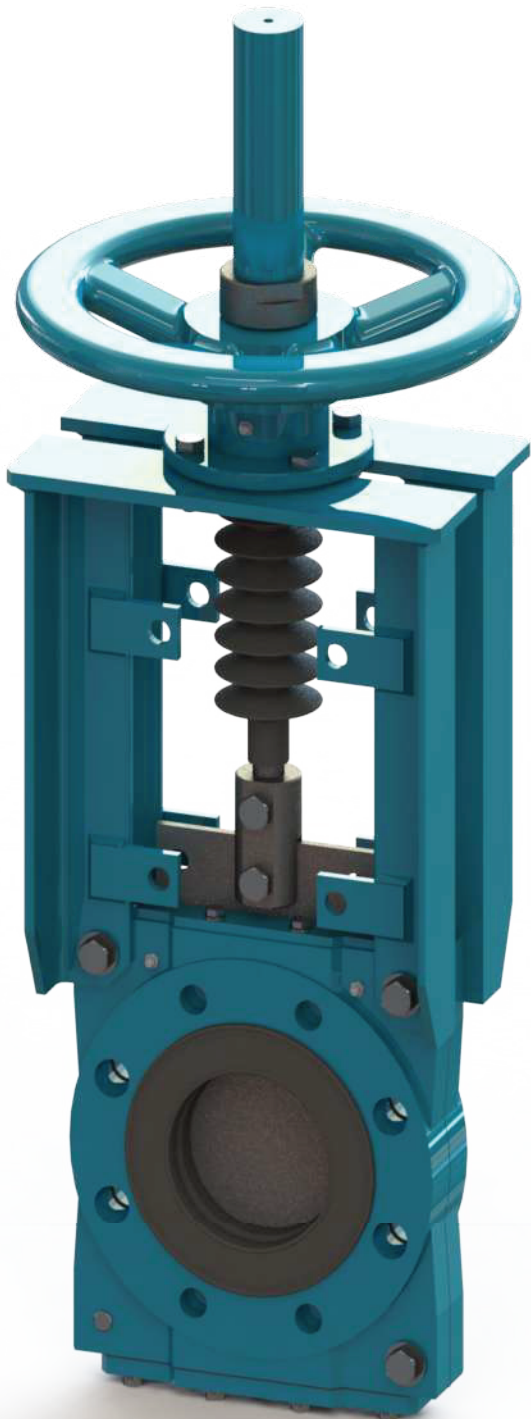

rhinoflexvalves.in

RLB100 is a bi-directional slurry valve, designed for high pressure slurry applications. Twin elastomer sleeves and push-through gate design facilitate self-cleaning and prevent media build up.

The durable ductile iron body is offered in a two-piece bolted flange style. When fully open, the valve is full bore, offering no resistance to passing media.

- Upper and lower protective stem cover is standard in all models, increasing cycle life in hazardous environments.
- Fully encapsulated sleeve reinforcement and memory assist, guaranteeing bidirectional zero leakage performance.
- In the open position, the energized sleeves shield all metal components from direct contact with the flowing process media.
- Gate available in a wide range of corrosion resistant alloys to suit the pressure rating and application.
- The design provides unobstructed flow path, extending sleeve life and minimizing pressure drop across valve.
- Flanged two-piece bolted body allows for easy maintenance and is drilled and tapped to country standards.
- Optional bottom flush plate with tapped ports, allows for safe discharge of media and easy flush water connection.
- When mounted between pipeline flanges, sleeves are compressed. Thus creating a tight sealing and allowing the Gate to travel smoothly during Opening & Closing.
- Split superstructure helps in removal of complete Gate assembly only by removing pneumatic cylinder fasteners.

Industries

- Mining & Minerals
- Power
- Pulp & Paper
- Alumina
- Chemical
- Cement

Technical Specifications

Size range *	DN50-DN600
Body style	Two piece bolted
End Connection	Wafer
Pressure rating	PN10 & PN16
Drilling *	ASME B16.5 #150 EN1092 PN10&16 BS10 Table D&E AS2129 Table D&E JIS10K
Face to Face	Industry Standard
Design Std.	Manufacturer's Std.
Testing Std.	Manufacturer's Std.

Standard MOC Option

Body *	Ductile Iron
Gate *	SS304
Seat *	Natural Rubber
Stem *	SS304

*Other Materials on request

SLURRY KNIFE GATE VALVES

RLB100

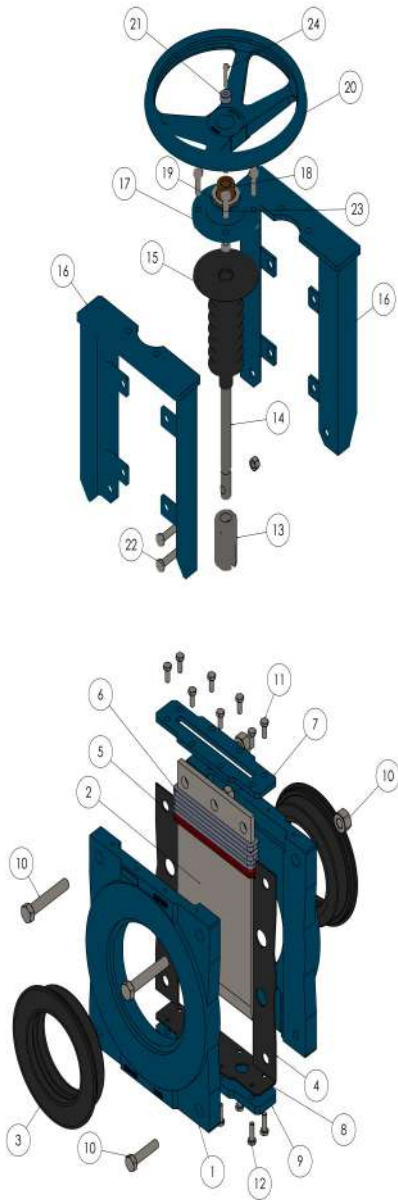

Item No.	Description	Material of Construction
1	Body	DI / WCB / CF8 / CF8M
2	Gate	SS304 / SS316
3	Seat	Natural rubber / EPDM / Nitrile
4	Packing	PTFE, Graphite & Aramide Combination
5	Gland	WCB / CF8 / CF8M
6	Fasteners (Body)	CS / SS
7	Fasteners (Gland)	CS / SS
8	Clevis	SS
9	Stem	SS304 / SS316
10	Yoke sleeve	Brass
11	Thrust bearing	SS
12	Fasteners (Clevis)	SS
13	Yoke	CS
14	Fasteners (Yoke)	CS / SS
15	Hand wheel	CI / CS

* Other Materials on request

SLURRY KNIFE GATE VALVES

RLB100

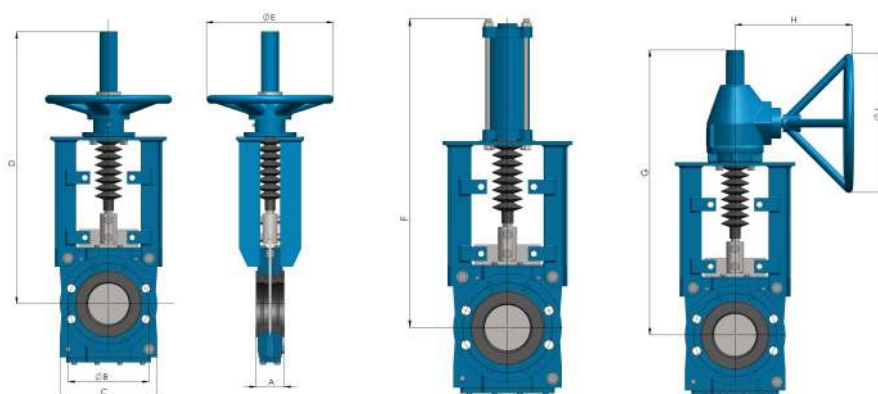

Dimensions in mm

Valve Size	A	*B	C	D	E	F	G	H	J
50	54	120.7	165	530	250	520	-	-	-
80	57	152.5	200	610	250	710	-	-	-
100	57	190.5	230	700	250	800	-	-	-
125	64	215.9	255	760	300	900	-	-	-
150	64	241.3	285	840	300	1000	890	310	300
200	76	298.5	345	970	400	1320	1190	310	500
250	76	362	405	1140	400	1525	1230	310	500
300	83	431.8	485	-	-	1640	1340	310	500
350	83	476.3	535	-	-	1875	1500	330	500
400	96	539.8	600	-	-	2000	1660	330	500
450	96	577.9	648	-	-	2200	1850	330	500
500	121	635	715	-	-	2350	2100	330	500
600	121	749.3	850	-	-	2530	2250	330	500

Dimensions in inch

Valve Size	A	*B	C	D	E	F	G	H	J
2	2.13	4.75	6.5	20.87	9.84	20.47	-	-	-
3	2.24	6.00	7.87	24.02	9.84	27.95	-	-	-
4	2.24	7.50	9.06	27.56	9.84	31.5	-	-	-
5	2.52	8.50	10.03	29.92	11.81	35.43	-	-	-
6	2.52	9.50	11.22	33.07	11.81	39.47	35.04	12.20	11.81
8	2.99	11.75	13.58	38.19	15.75	51.97	46.85	12.20	19.69
10	2.99	14.25	15.94	44.88	15.75	60.04	48.43	12.20	19.69
12	3.27	17.00	19.09	-	-	64.57	52.76	12.20	19.69
14	3.27	18.75	21.06	-	-	73.82	59.06	12.99	19.69
16	3.78	21.25	23.62	-	-	78.74	65.35	12.99	19.69
18	3.78	22.75	25.51	-	-	86.61	72.83	12.99	19.69
20	4.76	25.00	28.14	-	-	92.52	82.68	12.99	19.69
24	4.76	29.50	33.46	-	-	99.61	88.68	12.99	19.69

* In conformance with ASME B16.5, Class 150 for sizes NPS 2 (DN50) through NPS 24 (DN600).

RHINO FLEX INDIA PRIVATE LIMITED

SM-430, 2nd Gate Industrial Estate Near Flowserve Microfinish Gokul Road, Hubballi-580023 Karnataka, India

Web: www.rhino flex valves.in

Email: sales@rhino flex valves.in